

REV	DESCRIPTION	DATE	APPR
A	2020 STRUT WAS 6"	9/17/21	

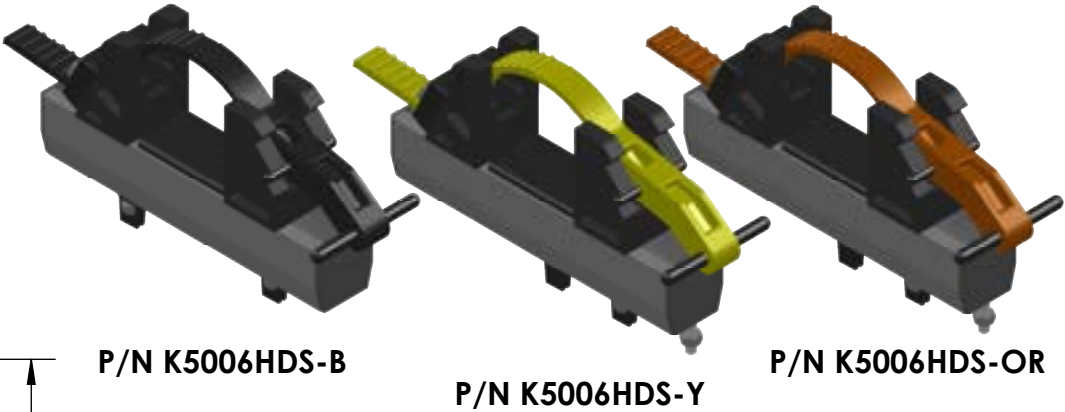

8	1006-903	ADJUSTAMOUNT KIT	1	A
7	1006-904	ADJ. LOCK END ASSEMBLY	1	A
6	2020EC	END CAP PAC STRUT HD	2	
5	7029	FASTENER KIT-ADJUSTAMOUNT PT	1	
4	2035	FASTENER PACK	1	
3	8006-2	CHANNEL CUSHION 2-1/2" LG	1	
2	2008	LOCK STRAP	1	
1	2020 (8")	8" LG PAC STRUT HD	1	
ITEM NO.	PAC P/N	PART NAME	QTY.	REV

NOTES:

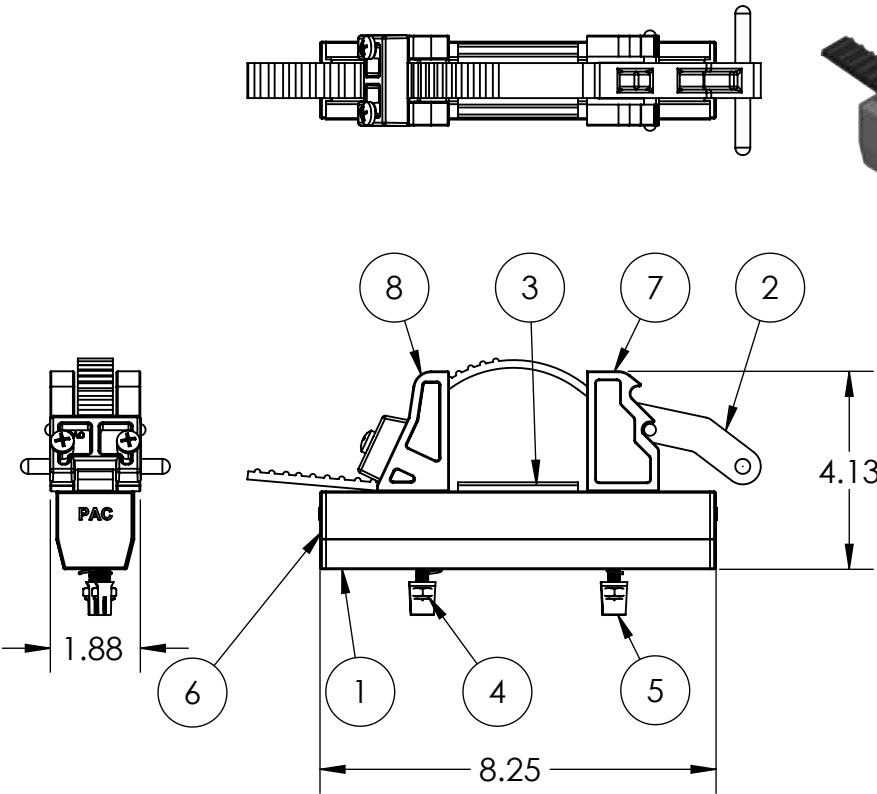

TOLERANCES UNLESS OTHERWISE SPECIFIED

.X= ±.03
.XX= ±.010
.XXX= ±.005
.XXXX= ±0.0005
ANGLES ±0.5 °
FRACTIONAL ±1/64

THIRD ANGLE PROJECTION

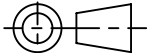

COLOR

NAME	DATE
DRAWN BY JPG	12-20-19
APPR. BY	
MFG BY	
MFG. P/N	
ENG APPR.	
MATERIAL	
ALT. MATERIAL	
FINISH	

THE INFORMATION CONTAINED IN THIS DRAWING IS THE SOLE PROPERTY OF **PERFORMANCE ADVANTAGE CO.** ANY REPRODUCTION IN PART OR AS A WHOLE WITHOUT THE WRITTEN PERMISSION OF PERFORMANCE ADVANTAGE CO. IS PROHIBITED.

TITLE:	
ADJUSTAMOUNT KIT HD SHORT	
PART NUMBER	REV
K5006HDS	A
SCALE: 1:4	