

REV	DESCRIPTION	DATE	APPR

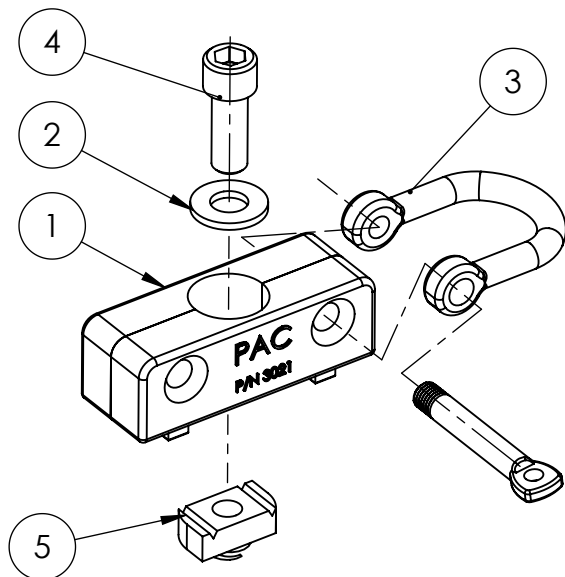

5	2083	3/-18 CHANNEL NUT	2
4	2079	3/8-16 X 1" S.H.C.S. S.S.	2
3	3021-401	SHACKLE S.S.	2
2	2081	3/8 SS FLAT WASHER	2
1	3021P	TIE DOWN MOUNT BASE	2
ITEM NO.	PAC P/N	PART NAME	QTY.

### NOTES:

MAX. LOAD RATING TO BE 250LBS  
SOLD IN PAIRS

COMPATIBLE WITH:  
PAC DUAL TRAC  
PAC MINI DUAL TRAC  
PAC STRUT

**P**ERFORMANCE  
**A**DVANTAGE  
**C**OMPANY



### TOLERANCES UNLESS OTHERWISE SPECIFIED

.X= ±.03  
.XX= ±.010  
.XXX= ±.005  
.XXXX= ±0.0005  
ANGLES ±0.5°  
FRACTIONAL ±1/64

### THIRD ANGLE PROJECTION

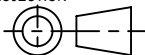

COLOR

NAME	DATE
DRAWN BY	
APPR. BY	
MFG BY	
MFG. P/N	
ENG APPR.	
MATERIAL	
ALT. MATERIAL	
FINISH	

THE INFORMATION CONTAINED IN THIS DRAWING IS THE SOLE PROPERTY OF **PERFORMANCE ADVANTAGE CO.** ANY REPRODUCTION IN PART OR AS A WHOLE WITHOUT THE WRITTEN PERMISSION OF PERFORMANCE ADVANTAGE CO. IS PROHIBITED.

### TITLE:

**TIE DOWN MOUNT**

### PART NUMBER

**K3021**

REV

**SCALE: 1:2**

**SHEET 1 OF 4**